

User Guide

Model LF13-HL





Table of Contents

	Pages
1. Features	3
2. Parts, Specifications	4
3. Front Color Options	5
4. Card/Passcode Levels	6
5. LEDs & Melody Sounds	7
6. How to Use	8-9
7. Change Modes & Functions	10
8. Battery Replacement, Emergency Power	11
9. Punching Installation Holes	12
10. Emergency Opening by Force	13



Features

Ok Digital's LF series are the most intuitive and convenient digital furniture lock that incorporates 20 years of accumulated technology and know-how.

RF/Passcode type model LF13-HL provides,

- Supports 13.56 MHz RF tag and passcode
- Long battery life with mechanical type in-use indicator (18 months with 3 alkaline batteries, 10 times per day)
- Stronger security through three levels key management system
- Emergency power supply through micro-USB
- Ergonomic and trendy front design

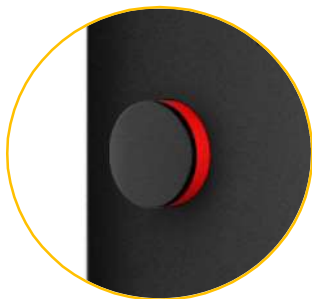

In-use Indicator



Imaginary Number



Micro USB
Emergency Power



Ellipse
Front Design



Wide-gap
Button



Parts, Specifications

LF13-HL

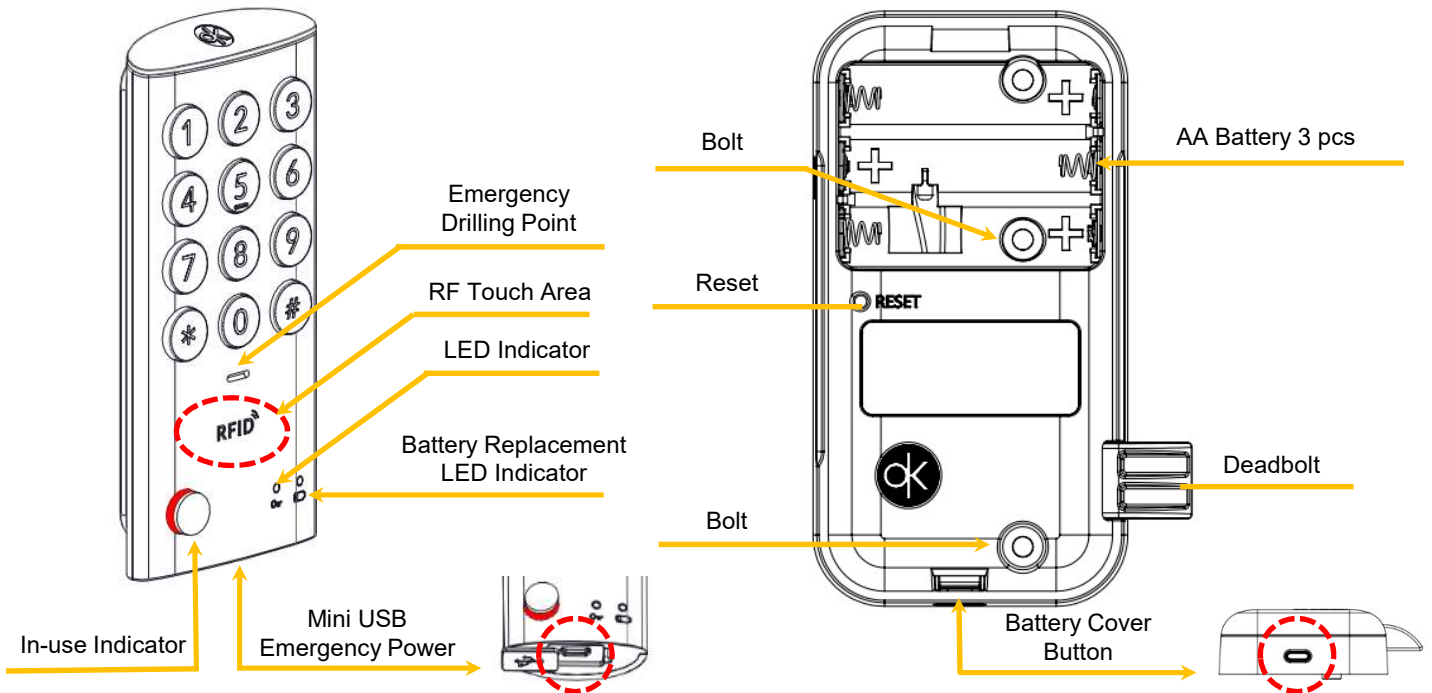

Package included

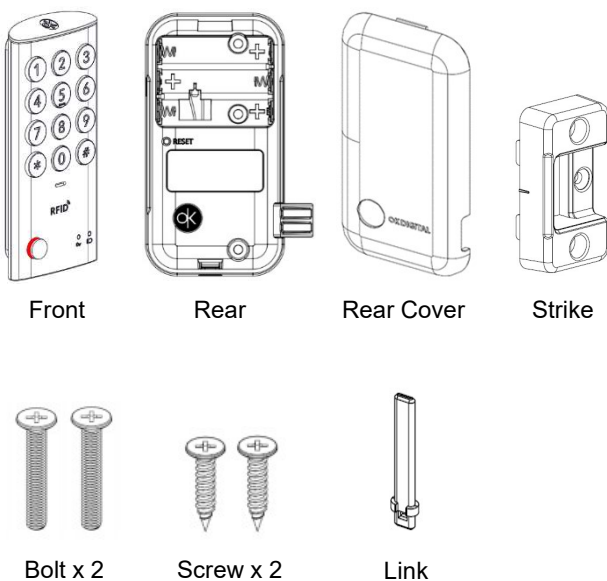

Specifications

Authentication	13.56 MHz RFID Card, Passcode
Key Level	Owner card(1), Master card(1~5), Cleaning card(1~5), User card(1~5), User code(4~12digits)
Front Size	57(W) X 112.7(H) X 19(T) mm
Rear Size	66(W) X 125(H) X 25(T) mm
Battery	3 AA Alkaline Batteries (+4.5V DC)
Battery Life	Up to 18 months (10 times per day)
Material	PC, ABS Alloy
Front Color	Black/Silver or White/Silver
Rear Color	Black
Door Thickness	15mm, 18mm, 20mm
Supported Mode	Public, Private
Environment	-15°C ~ 55 °C, 95 %RH

- ❖ Link will be provided with an adequate size that fits the door thickness.
- ❖ Cleaning with soft fabric. Do not use benzene, thinner or gasoline.
- ❖ In-door use only



Front Color Options

LF13-HL



LF13-HL-BK



LF13-HL-WH



LF13-HL-BR



LF13-HL-BU



LF13-HL-GR







LF13-HL-GY

Standard color: Black(BK), White(WH)

Optional color: Brown(BR), Blue(BL), Green(GR), Gray(GY)

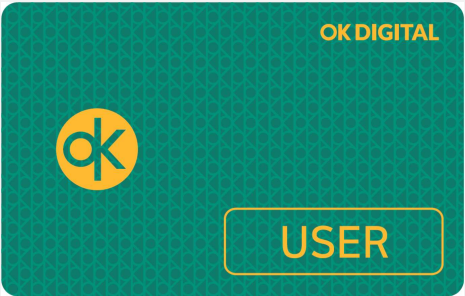

Card/Passcode Levels

Card Level	No. of Card	Functions
	1 Card only	<ul style="list-style-type: none">• Top level card but cannot lock or unlock• Only one Owner card can be registered• First touched card became Owner card• Register or delete Master card and Cleaner card• Change modes and functions• Owner card can be changed by Owner card
	5 Card only	<ul style="list-style-type: none">• Second level management card• Can be registered up to five Master card by Owner card• Register or delete User card• Unlock the lock and but the User card will be deleted right after use master card• The lock will be stay opened when it opened with Master card.
	5 (Card) 1 (Passcode)	<ul style="list-style-type: none">• Card or Passcode• Lock or unlock• Up to five User cards and one User passcode can be registered by Master card• Register all User cards when lost any one of the User card
	5 Card only	<ul style="list-style-type: none">• Unlock the lock, automatically locked after use• Can be registered up to five Cleaner cards by Owner card• Be aware use of the Cleaner card, It does not leave any traces of use. Cleaning purpose only• Factory default is “off – not using Cleaner card”. Change it to “on” by Owner card



LEDs & Melody Sounds

LED Indicator	Type	Light Colors	Purpose
	Key Icon	Green, Red, Yellow	Lock Status
	Battery Icon	Red	Battery Change Alarm

Status	Key LED, times	Bat. LED, times	Melody (times)
Press button	Green, 1	off	1
Entering change mode//function	Off	off	3
Incorrect passcode/card	Red, 4	off	4
Delete passcode/card	Red, 8	off	4
Unlock	Green, 3	off	4
Lock	Red, 3	off	3
Passcode/card deleted	off	off	6
Correct passcode/card	Green, 2	off	2
Not registered card	Red, 3	off	6
Mode changed	Green, 3	off	2
Reset	Yellow, 1	On, 1	1
Deadbolt jammed	Yellow, 2	On, 2	4
Emergency opening	Yellow, 2	On, 2	5 (10 seconds)
Battery change warning	off	On, 5	6
Passcode/card registered	Green, 3	off	2
Master passcode/card registration mode	Red (8 seconds)	off	none
User passcode/card registration mode	Green (8 seconds)	off	none
Card already registered	Red 2	off	5
Battery changed	off	off	5



How to Use

Register Owner Card

- Press button → touch any card marked “Owner”
- ❖ 1st touched card became Owner. Only 1 Owner card can be registered.

Change Owner Card

- → current Owner card (*touch for 8 seconds*) → *Melody* → new Owner card
- ❖ Even if change the owner key, all registered keys and functions are remaining the same.

Register/Change Master Card

- + Owner card (*press and touch Owner card at the same time*) → *Melody* → any card marked “Master” up to five
- ❖ Master can be registered up to five or touch same card twice to stop the registration.
Ex.: + Owner → Master 1 → Master 2 → Master 2
✓ Two Master cards has been registered.
- ❖ All previous Master cards will be deleted as soon as a new Master card is registered

Use Master Card (unlock & delete all User cards/code)

- + Master card
- ❖ It deletes all User cards and User code. The lock will be stay opened when it opened with Master card.

Register/Change Cleaner Card

- + Owner card (*4 seconds*) → *Melody* → any card marked “Cleaner” up to five
- ❖ Cleaner card can be registered up to 5 or touch same card twice to stop the registration.
- ❖ All previous Cleaner cards will be deleted as soon as a new Cleaner card is registered

Use Cleaner Card

- → Cleaner card
- ❖ Automatically locked after use of the Cleaner card (Private & Public)
- ❖ Be aware use of Cleaner card. It does not leave any traces of use.



How to Use

Register/Change User Card or User Code (Private)

- * + Master card → *Melody* → touch any card marked "User" up 5
- * + Master card → *Melody* → User code (4 to 12 digits) → #
- ❖ Either one of User card or User code can open the lock.
- ❖ Previous User card and User code will be deleted as soon as a new User card/code is registered.
- ❖ Up to 5 User cards can be registered or touch same card twice to end the card registration.

Change User Code by User code (Private)

- # (4 seconds) → enter current User code → # → new User code → #

Use User Code (Public)

- Close door → enter 4 to 12 digits code → #
- Enter same code → # → open door
- ❖ User code will be deleted after use

Use User Code (Public) + Imaginary

- Close door → # → any codes + 4 digits User code → #
- # → any codes + same 4 digits User code → # → open door
- ❖ User code will be deleted after use
- ❖ Recorded last 4 digits only

Use User Code (Private)

- Automatically locked when close the door.
- Enter registered User code → # → open door
- ❖ Factory default User code is "1111"

Use User Code (Private) + Imaginary

- Automatically locked when close the door.
- # → any codes + registered code → # → open door
- ❖ Need to register the User code by Master Code



Change Modes & Functions

Mode	How To Use
Private Mode (Code)	<ul style="list-style-type: none">• Press 0 and touch Owner card at the same time❖ Lock should be unlocked to change mode.❖ User code is set to "1111".
Public Mode (Code)	<ul style="list-style-type: none">• Press 1 and touch Owner card at the same time❖ Lock should be unlocked to change the mode. Factory default mode: Public
Private / Public Mode (Card) (Toggle)	<ul style="list-style-type: none">• Press * and touch Owner card at the same time❖ Lock should be unlocked to change the mode. Factory default: Private
Melody On/Off (Toggle)	<ul style="list-style-type: none">• Press 2 and touch Owner card at the same time❖ Lock should be unlocked to change the mode. Factory default: On
Detect / Not Detect door status (Toggle)	<ul style="list-style-type: none">• Press 3 and touch Owner card at the same time❖ It detect or not detect the magnet in the strike. Factory default: Detect❖ Be aware to use "not detect door status mode". No burglar alarm when break to open the lock.
Cleaner Card On / Off (Toggle)	<ul style="list-style-type: none">• Press 5 and touch Owner card at the same time❖ Use or not use the Cleaner card. Factory default: Off
Delete all cards and passcode except Owner Card	<ul style="list-style-type: none">• Press 9 and touch Owner card at the same time❖ Lock will be unlocked
Volume Up and Down	<ul style="list-style-type: none">• Press 1 and # at the same time for 4 seconds to enter the volume control mode → press # for volume up or press * for volume down (5 steps)❖ Warning alarms such as opening by force will be maximum volume level even if the volume is set to low.



Battery Replacement, Emergency Power

Battery Replacement

1 | Open Battery Cover

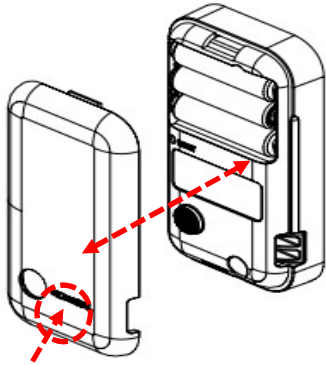

Plug in the battery cover until it clicks

- ① Need to replace the battery with new one when battery replacement LED is blinking.
 - ② Replacing the battery does not change all existing settings and codes.
- ※ Please make sure the battery cover is plugged in completely.

Emergency Power

2 | Use 5 pin mini-USB at the bottom of the front

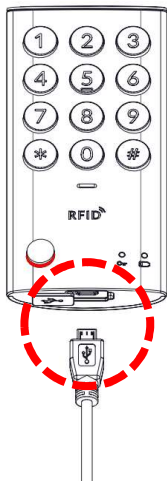

- ① Connect 5V mini-USB into the emergency power supply port.
- ② Open the lock with User Code or Master Code.
- ③ Replace the battery with new one.

※ Emergency power supply can be used when the battery is completely exhausted, and the lock is not working.

※ User code is deleted when the Master code is used.

- In Public mode, the lock will stay unlocked.
- In Private mode, the User code is deleted. Need to register a new User code.

Fault Diagnosis & First Aid

- Wrong User code or Master code 5 times : The lock will be freeze up for 30 seconds. Possible to try again after 30 seconds.
- Forget the User code : Use Master code to open the door
- Cannot lock the door : There is a warning alarm if the door is droop or clothes get stuck on the door. Fix the door or remove the cloth away from the door



Punching Installation Holes

Right Hand Door

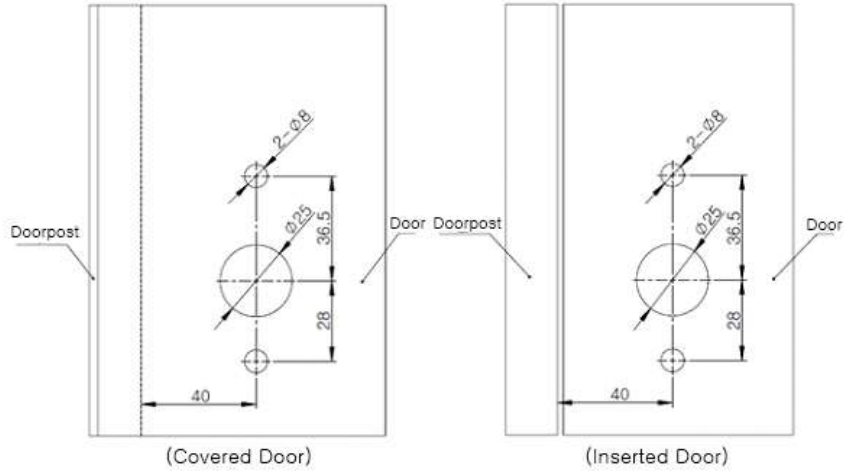

Left Hand Door

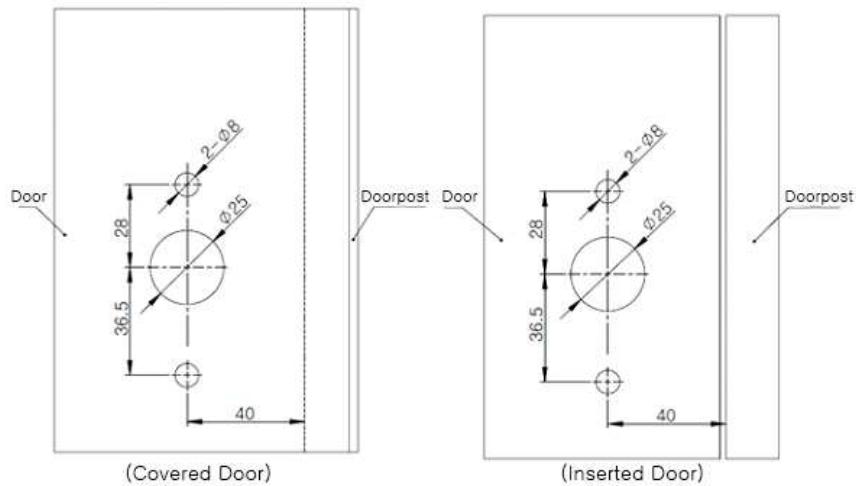

Two Door

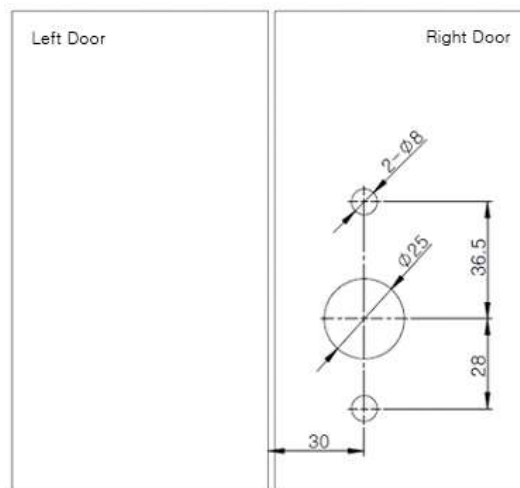



Emergency Opening by Force

Tools

Drill Bit (Option)

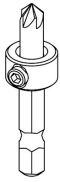

Electric Drill



“+” Screwdriver

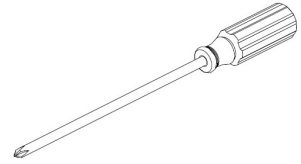

1

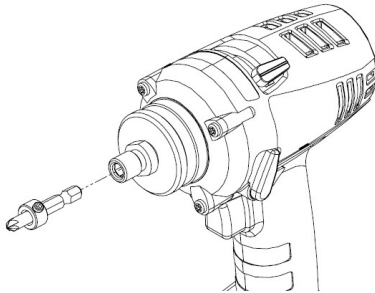

Insert the drill bit into the electric drill.

2

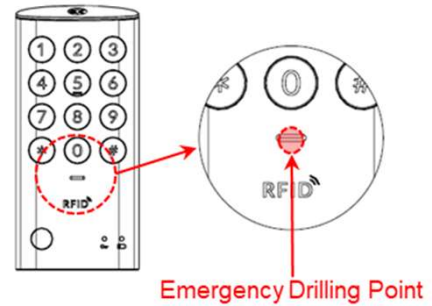

Check exact drilling point.

3

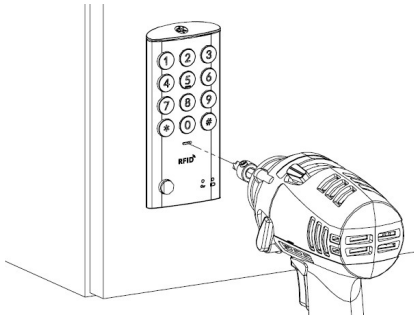

Drill to make a hole through the drilling point.

4

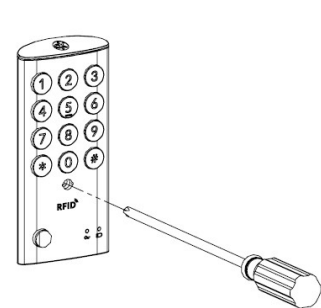

Insert “+” screwdriver into the hole.

5

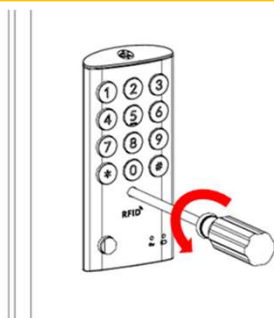

Turn the driver count-clockwise.

6

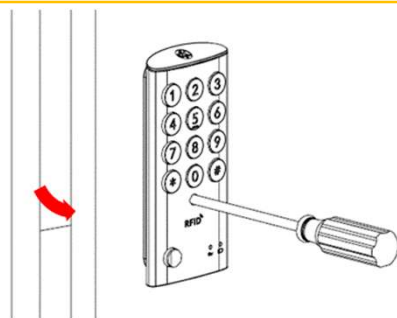

Open the door.

❖ There will be warning alarms for 20 seconds at the maximum volume when the door is opened by force.

OK Digital Co., Ltd.

#1510 Mega Bldg. SKn Techno Park
124 Sagimakgol-ro, Seongnam-si, Gyeonggi-do 13207
T) +82-1577-5351 F) +82-31-759-0331
www.okdigital.co.kr



Copyright© OK Digital Co., Ltd. All Rights Reserved.